

Transient Voltage Suppressors for ESD Protection

SE03D5S01HZ

Features

- ◆ Working voltages: 3.3V
- ◆ Low capacitance
- ◆ Low leakage current: 0.1 μ A @ V_{RWM}
- ◆ Low clamping voltage
- ◆ Response Time is < 1 ns

SOD-523

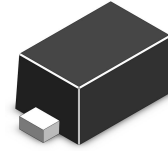

Applications

- ◆ Cell Phone Handsets and Accessories
- ◆ Microprocessor based equipment
- ◆ Personal Digital Assistants (PDA's)
- ◆ Notebooks, Desktops, and Servers

Functional Diagram

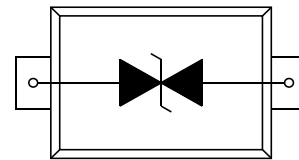

Mechanical Characteristics

- ◆ SOD-523 Package
- ◆ Molding Compound Flammability Rating : UL 94V-0
- ◆ Quantity Per Reel : 3,000pcs
- ◆ Reel Size : 7 inch

Mechanical Characteristics

Symbol	Parameter	Value	Units
T_{LST}	Lead Soldering Temperature	260 (10sec)	$^{\circ}$ C
T_{STG}	Storage Temperature Range	-55 to +150	$^{\circ}$ C
T_{OPT}	Operating Temperature Range	-55 to +125	$^{\circ}$ C
V_{ESD}	ESD per IEC 61000-4-2(Air)	\pm 30	KV
	ESD per IEC 61000-4-2 (Contact)	\pm 30	

Transient Voltage Suppressors for ESD Protection

SE03D5S01HZ

I-V Curve Characteristics

Symbol	Parameter
I_{PP}	Maximum Peak Pulse Current
V_C	Clamping Voltage @ I_{PP}
V_{RWM}	Working Peak Reverse Voltage
I_R	Maximum Reverse Leakage Current @ V_{RWM}
V_{t1}	Trigger Voltage
I_{t1}	Trigger Current @ V_{t1}
V_h	Holding Voltage
I_h	Holding Current @ V_h

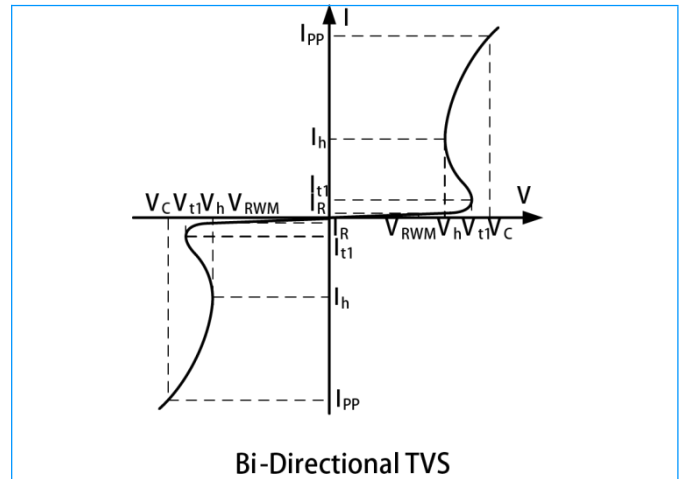

Electrical Characteristics (@ 25°C Unless Otherwise Specified)

Symbol	Test Condition	Minimum	Typical	Maximum	Units
V_{RWM}	--	--	--	3.3	V
I_R	$V_{RWM} = 3.3V, T = 25^\circ C$	--	--	0.1	μA
V_{BR}	$I_t = 1mA$	3.4	4.0	--	V
V_C	$I_{PP} = 1A, t_p = 8/20\mu s$	--	5	--	V
V_C	$I_{PP} = 8A, t_p = 8/20\mu s$	--	8	--	V
C_J	$V_R = 0V, f = 1MHz$	--	12	--	pF

Characteristic Curves

Fig1. 8/20 μs Pulse Waveform

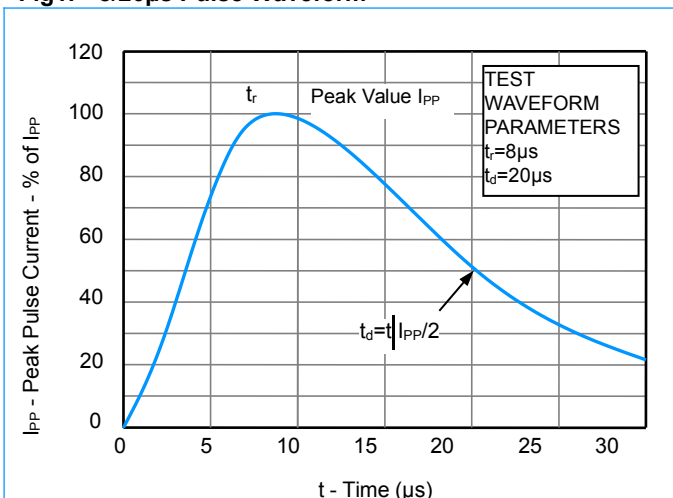
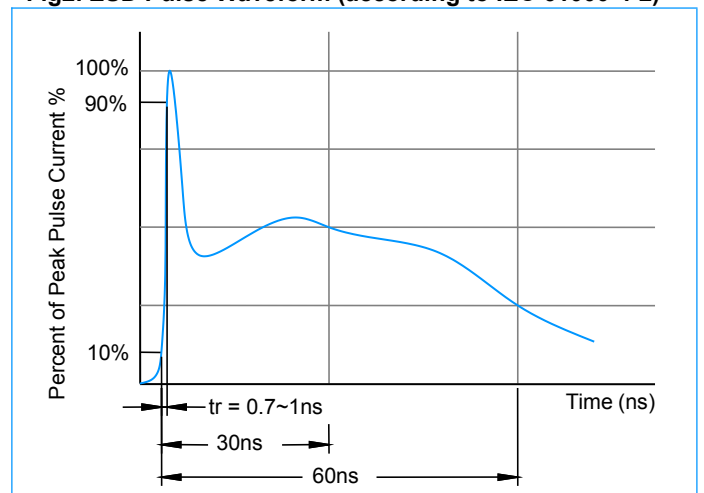

Fig2. ESD Pulse Waveform (according to IEC 61000-4-2)



Transient Voltage Suppressors for ESD Protection

SE03D5S01HZ

Characteristic Curves (Continue)

Fig3. ESD Clamping (+8KV Contac per IEC61000-4-2)

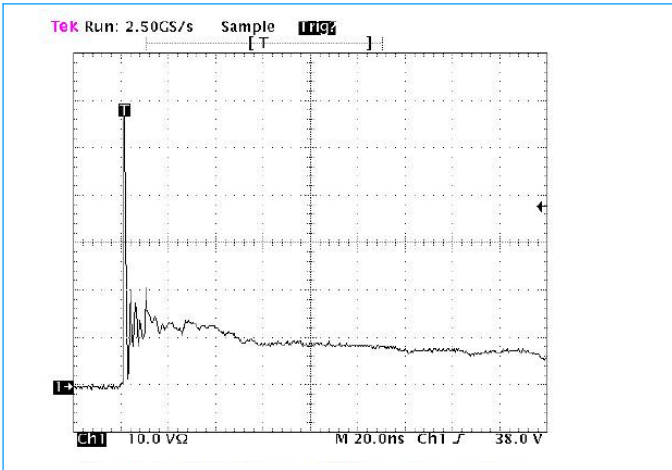
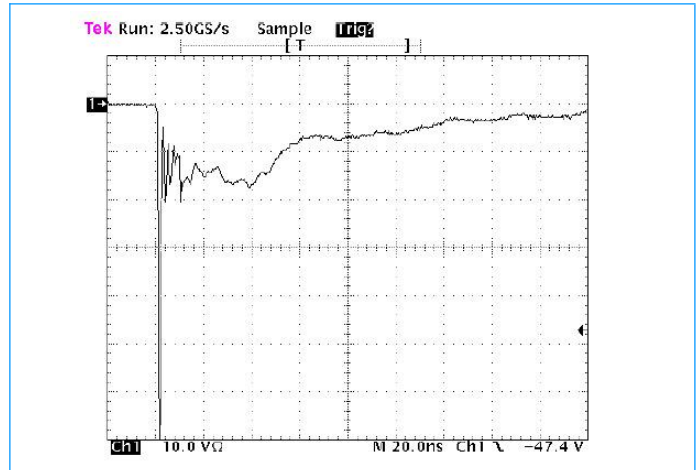
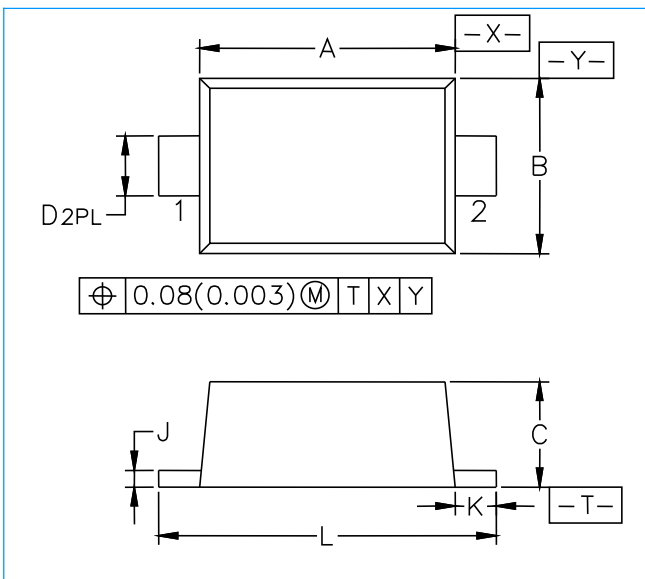

Fig4. ESD Clamping (-8KV Contac per IEC61000-4-2)



SOD-523 Package Outline & Dimensions



Symbol	Millimeters			Inches		
	Min.	Nom.	Max.	Min.	Nom.	Max.
A	1.10	1.20	1.30	0.043	0.047	0.051
B	0.70	0.80	0.90	0.028	0.032	0.035
C	0.50	0.60	0.70	0.020	0.024	0.028
D	0.25	0.30	0.35	0.010	0.012	0.014
J	0.07	0.14	0.20	0.0028	0.0055	0.0079
K	0.15	0.20	0.25	0.006	0.008	0.010
L	1.50	1.60	1.70	0.059	0.063	0.067

Soldering Footprint

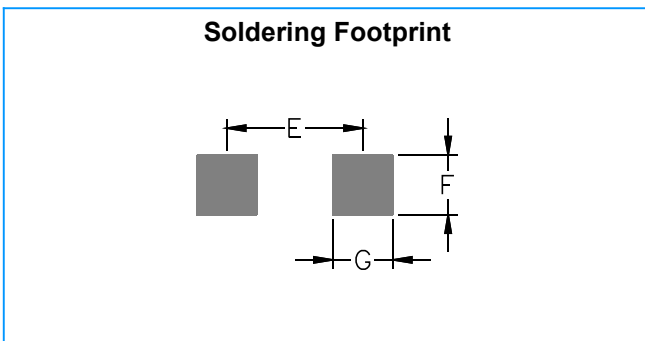

Symbol	Millimeters	Inches
E	1.40	0.0547
F	0.40	0.0157
G	0.40	0.0157